

PULP BALE CLAMPS
RECYCLING CLAMPS
FOAM CLAMPS

S15

Bale clamps enable handling of bales of pulp, paper and textiles.

Pulp bale clamps have solid, slim arms to facilitate handling of extremely tightly stacked goods. For better grip, the contact surfaces are equipped with end-to-end bars. Combining attachments with a rotator allows the inversion of bales.

Recycling clamps have wide arms with ribbed contact surfaces. They are suited for handling goods that are flexible enough to be pressed into the spaces between the ribs.

The arms of foam clamps are made of hoop-shaped tubular material for careful handling of foam bales. The opening range compared to bale clamps is wider.

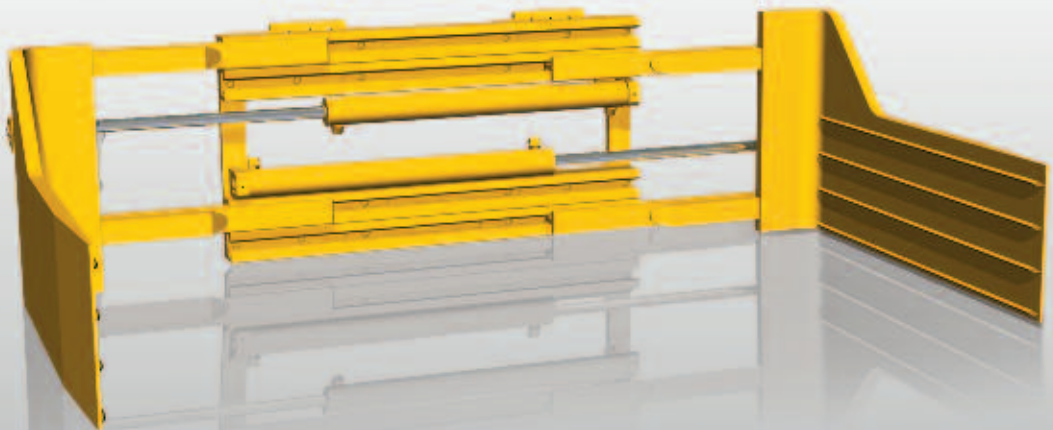

Pulp Bale Clamps Model S 15 - BKZ

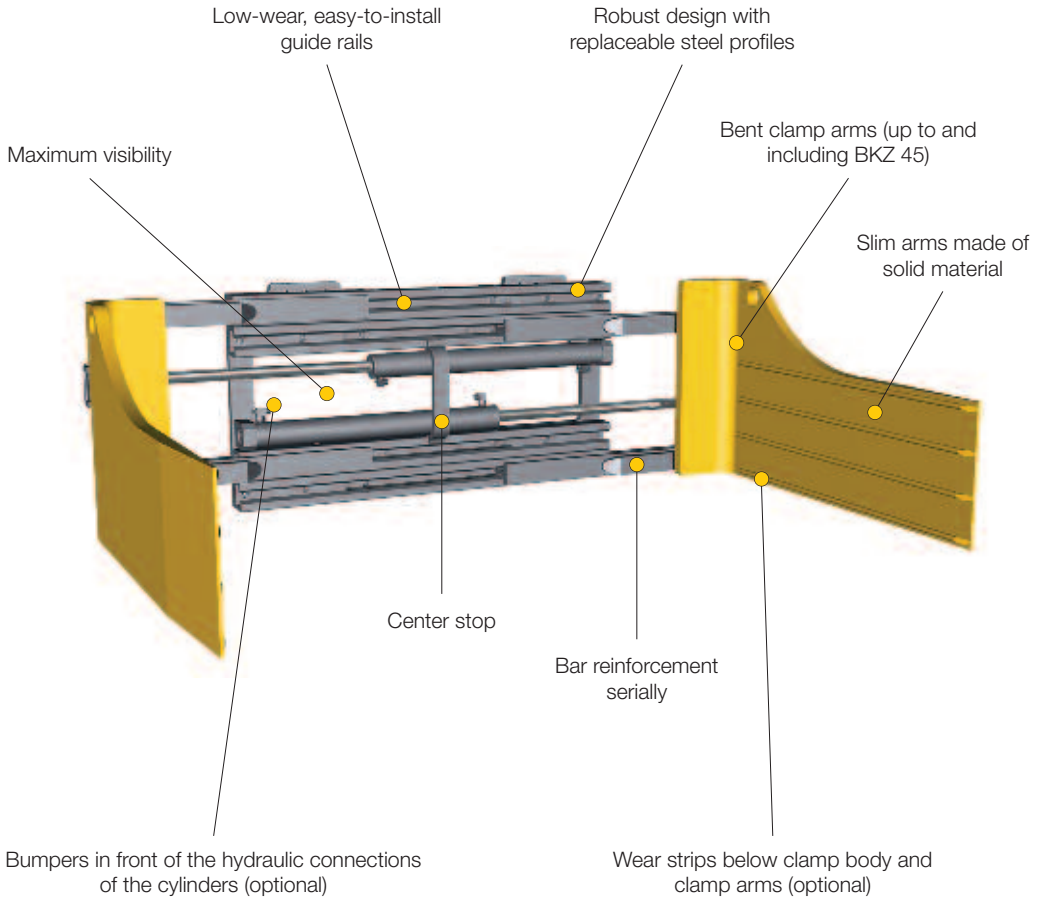

S15



Pulp Bale Clamps, Rotatable

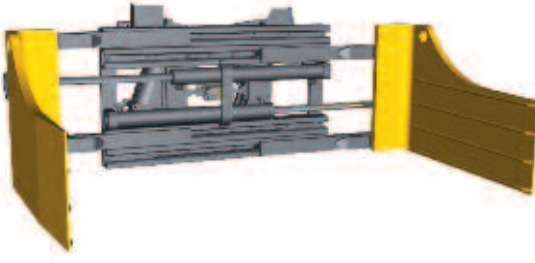

Model S 15 - BKZ ... 360°

- Rotation range of 360° continuous by means of a worm gear
- Protected lateral drive
- Center stop
- Excellent visibility due to low height
- Large centered opening enables good visibility

Recycling Clamps

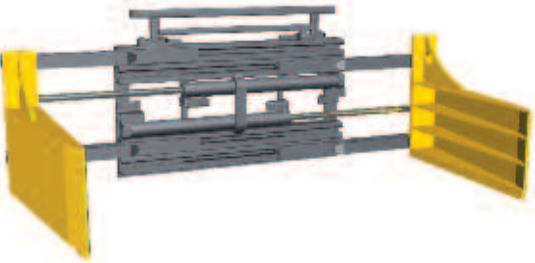

Model S 15 - BKR

- Wide arms with ribbed contact surfaces
- Wear strips below clamp body and clamp arms serially
- Center stop
- Bumpers in front of the hydraulic connections of the cylinders serially

Foam Clamps

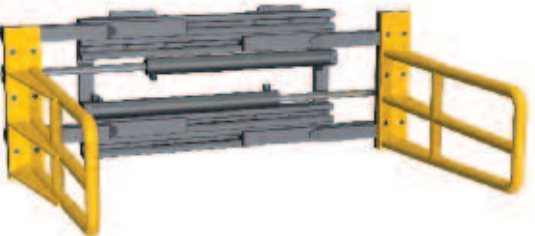

Model S 15 - BKS

- Clamping arms made of hoop-shaped tubular material
- Bolt-on arms
- Bar reinforcement serially
- Damage-free clamping

Pulp Bale Clamps with Sideshift Valve

2 hydraulic functions

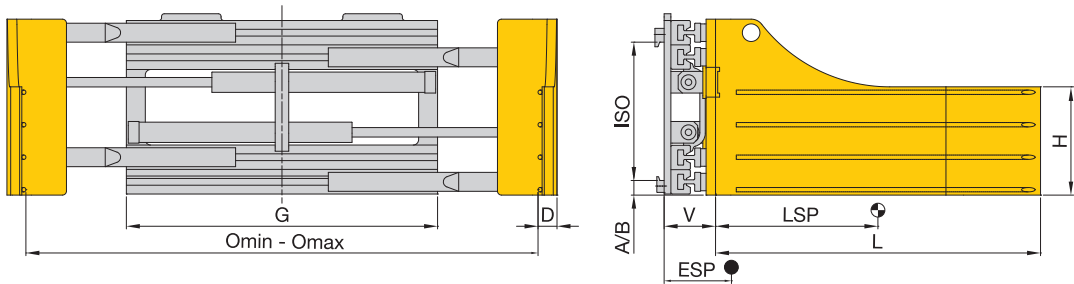

Incl. Center stop · Bent clamp arms up to BKZ 45-SV

Model	Load capacity	LC (LSP)	ISO	Omin-Omax	G	L	H	D	V	CoG (ESP)	Weight	Price	Surcharge per 100 mm add. arm length or height
	kg	mm		mm	mm	mm	mm	mm	mm	mm	mm	kg	€
S 15 - BKZ 15-SV	1500	500	2	500-1560	950	800	400	30	160	195	385	7,245.-	95.-
				560-1720	1050	800	400	30	160	190	395	7,470.-	95.-
				560-1790	1050	800	400	30	160	190	395	7,550.-	95.-
S 15 - BKZ 22-SV	2200	500	2	560-1830	1150	1000	400	46	185	255	610	9,105.-	120.-
				560-1890	1150	1000	400	46	185	255	615	9,220.-	120.-
				650-2020	1250	1000	400	46	185	250	625	9,525.-	120.-
				650-2170	1250	1000	400	46	185	250	630	9,640.-	120.-
S 15 - BKZ 28-SV	2800	500	3	560-1830	1150	1000	400	51	190	270	670	9,925.-	130.-
				560-1890	1150	1000	400	51	190	270	675	10,155.-	130.-
				650-2020	1250	1000	400	51	190	265	690	10,490.-	130.-
				650-2170	1250	1000	400	51	190	265	705	10,725.-	130.-
S 15 - BKZ 35-SV	3000	600	3	560-1900	1250	1200	400	51	200	300	815	11,470.-	140.-
				560-2000	1250	1200	400	51	200	300	820	11,720.-	140.-
				560-2000	1350	1200	400	51	200	295	830	12,075.-	140.-
				560-2100	1350	1200	400	51	200	295	835	12,330.-	140.-
				650-2190	1450	1200	400	51	200	290	860	12,685.-	140.-
S 15 - BKZ 40-SV	3900	600	3	560-2380	1450	1200	400	51	200	290	870	12,940.-	140.-
				560-2000	1350	1200	400	56	205	315	885	13,180.-	150.-
				560-2100	1350	1200	400	56	205	315	890	13,455.-	150.-
				650-2190	1450	1200	400	56	205	310	920	13,820.-	150.-
S 15 - BKZ 45-SV	4200	600	4	560-2380	1450	1200	400	56	205	305	930	14,085.-	150.-
				560-2000	1350	1200	400	56	205	310	990	14,050.-	170.-
				560-2100	1350	1200	400	56	205	310	995	14,325.-	170.-
				650-2190	1450	1200	400	56	205	305	1035	14,690.-	170.-
				650-2380	1450	1200	400	56	205	300	1045	14,910.-	170.-

S 15

Pulp Bale Clamps with Sideshift Valve

2 hydraulic functions

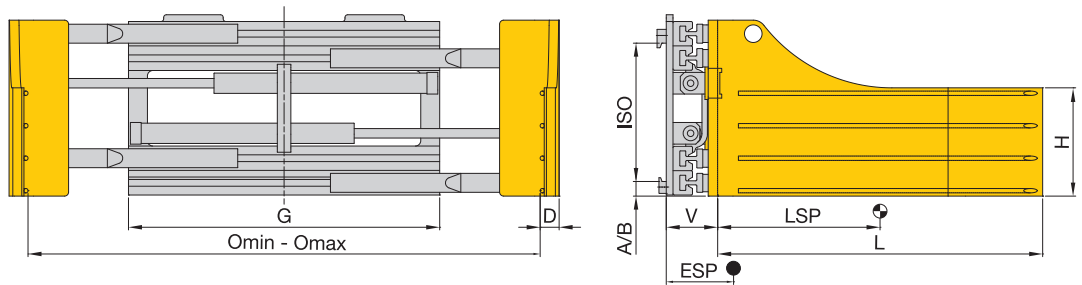

Incl. center stop

Model	Load capacity	LC (LSP)	ISO	Omin-Omax	G	L	H	D	V	CoG (ESP)	Weight	Price	Surcharge per 100 mm add. arm length or height
S 15 - BKZ 50-SV	5000	600	4	650-2490	1600	1200	400	61	225	285	1335	19,415.-	190.-
				650-2650	1750	1200	400	61	225	265	1455	20,340.-	190.-
S 15 - BKZ 70-SV	5700	700	4	650-2650	1750	1400	500	66	225	355	1665	23,795.-	235.-
				650-2900	2000	1400	500	66	225	340	1745	25,150.-	235.-
S 15 - BKZ 80-SV	6500	800	4	670-2800	2000	1600	600	70	260	370	2290	On request	
				670-3000	2200	1600	600	70	260	360	2370	On request	
S 15 - BKZ 100-SV	8000	800	4	700-3100	2400	1600	600	80	265	365	2550	On request	

- Surcharge for wear strips below clamp body and clamp arms
 - up to BKZ 22-SV **€ 295.-**
 - up to BKZ 40-SV **€ 455.-**
 - up to BKZ 70-SV **€ 685.-**
 - up to BKZ 100-SV on request.
- Surcharge for bumpers in front of the connections of the adjusting cylinders
 - up to BKZ 22-SV **€ 515.-**
 - up to BKZ 40-SV **€ 590.-**
 - up to BKZ 70-SV **€ 725.-**
 - up to BKZ 100-SV on request.
- Surcharge for adjustable pressure relief valve **€ 320.-**
- Surcharge for pressure gauge **€ 120.-**
- Surcharge for load backrest see page 174.
- Version with one oscillating arm on request.
- Further opening ranges and higher load capacities on request.
- Details on sideshift valve, see page 9.
- Available without sideshift.
- The opening range between the clamp arms is measured on the frame.
Due to a prestress (1°) the opening range between the tips is correspondingly smaller.

See page 132 for standard values for the residual load capacity of lift trucks.

Standard values for residual load capacity of lift trucks**

Pulp Bale Clamps (see page 130/131)

Pulp Bale Clamps with Sideshift Valve	S 15 -	BKZ 15-SV	BKZ 15-SV	BKZ 22-SV	BKZ 22-SV	BKZ 28-SV	BKZ 28-SV	BKZ 35-SV	BKZ 35-SV	BKZ 40-SV	BKZ 40-SV	BKZ 45-SV	BKZ 50-SV	BKZ 70-SV
Load capacity lift truck	kg	1500	2000	2000	2500	3000	3500	4000	4500	4500	5000/500	5000	6000	7000
X*	mm	350	450	450	450	450	500	500	500	500	500	560	560	650
LC (LSP) = 500 mm	kg	1150	1635	1440	1875	2255	2735	3035	3470	3400	3895	4300	4980	6030
LC (LSP) = 600 mm	kg	1045	(1380)	1320	1715	2065	2515	2795	3195	3130	3585	3970	4600	5600
LC (LSP) = 800 mm	kg	880	(1030)	1130	1470	1770	(1925)	2410	(2475)	2700	3090	3445	4000	4900

** The load capacity applies to lifting heights up to 3300 mm; specifications for greater lifting heights on request.

* Assumed dimensions

- For greater load centers, where the lift truck has a higher residual load capacity than the attachment, those values, upon the exceedance of which the attachment would be overloaded, are indicated in brackets ().

Special Products

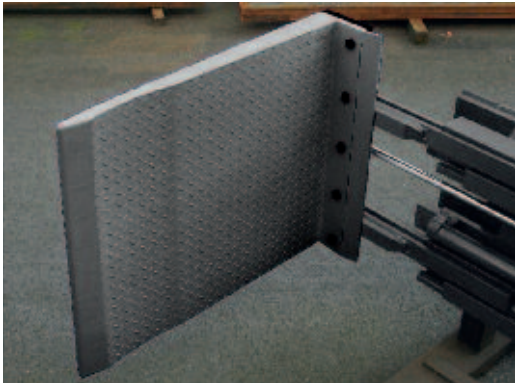

S15

Pulp Bale Clamps, Rotatable

2 hydraulic functions

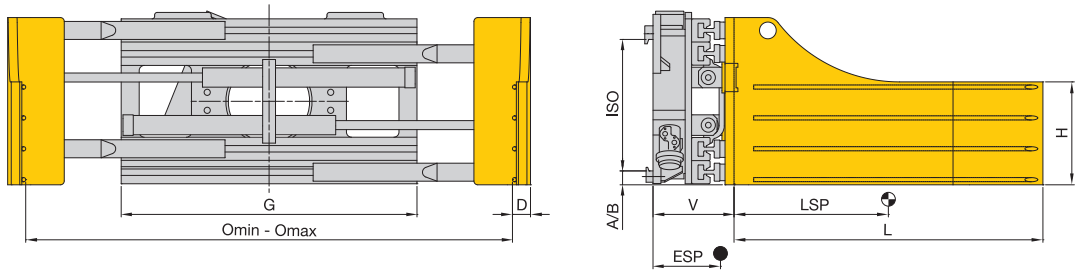

Incl. center stop · Bent clamp arms · Rotation range 360°

Model	Load capacity	LC (LSP)	ISO	Omin-Omax	G	L	H	D	V	CoG (ESP)	Weight	Price	Surcharge per 100 mm add. arm length or height	Surcharge for sep. sideshift
S 15 - BKZ 15-360°	1500	500	2	560-1720	1050	800	400	30	280	215	635	14,575.-	95.-	1,860.-
S 15 - BKZ 22-360°	2200	500	2	560-1890	1150	1000	400	46	290	280	790	15,700.-	120.-	1,860.-
S 15 - BKZ 28-360°	2800	500	3	560-1890	1150	1000	400	51	315	295	930	17,770.-	130.-	2,195.-
S 15 - BKZ 35-360°	3000	600	3	560-2100	1350	1200	400	51	335	325	1150	21,200.-	140.-	2,260.-

- Surcharge for wear strips under clamp body and arms up to BKZ 22-360° **€ 295.-**
- Surcharge for wear strips under clamp body and arms up to BKZ 35-360° **€ 455.-**
- Surcharge for bumpers in front of the connections of the adjusting cylinders up to ISO 2 **€ 515.-**
- Surcharge for bumpers in front of the connections of the adjusting cylinders up to ISO 3 **€ 590.-**
- Surcharge for adjustable pressure relief valve **€ 320.-**
- Surcharge for pressure gauge **€ 120.-**
- Surcharge for solenoid valve with separate sideshift (utilization of only rotation/sideshift admissible) **€ 920.-**
- Further opening ranges on request.
- Higher load capacities on request.
- The opening range between the clamp arms is measured on the frame.
Due to a prestress (1°) the opening range between the tips is correspondingly smaller.

Standard values for residual load capacity of lift trucks**

Pulp Bale Clamps, rotatable	S 15 -	BKZ 15-360°	BKZ 15-360°	BKZ 22-360°	BKZ 28-360°	BKZ 28-360°	BKZ 35-360°	BKZ 35-360°	BKZ 35-360°
Load capacity lift truck	kg	1500	2000	2500	3000	3500	4000	4500	5000/500
X*	mm	350	450	450	450	500	500	500	500
LC (LSP) = 500 mm	kg	900	1330	1590	1860	2300	2500	2890	3330
LC (LSP) = 600 mm	kg	820	1230	1470	1720	2130	2315	2680	3090
LC (LSP) = 800 mm	kg	710	(1030)	1275	1495	1860	2025	2340	(2480)

** The load capacity applies to lifting heights up to 3300 mm; specifications for greater lifting heights on request.

* Assumed dimensions

- For greater load centers, where the lift truck has a higher residual load capacity than the attachment, those values, upon the exceedance of which the attachment would be overloaded, are indicated in brackets ().

Recycling Clamps with Sideshift Valve

2 hydraulic functions

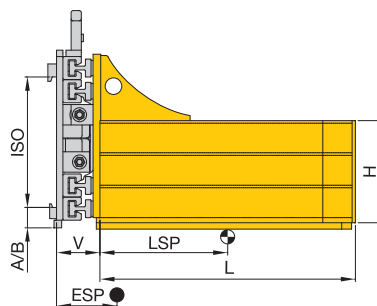
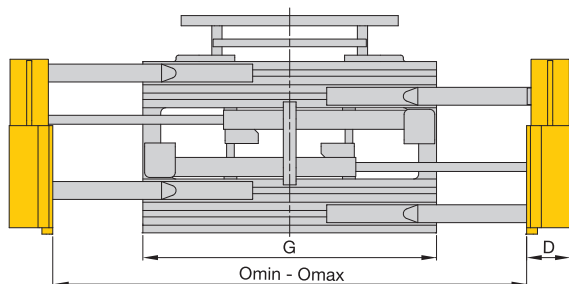

Wear-strips serially below the clamp body and clamp arms as well as a center stop and bumpers in front of the hydraulic connections

Model	Load capacity	LC (LSP)	ISO	Omin-Omax	G	L	H	D	V	CoG (ESP)	Weight	Price	Surcharge per 100 mm add. arm length or height
	kg	mm		mm	mm	mm	mm	mm	mm	mm	kg	€	
S 15 - BKR 15-SV	1500	500	2	500-1700	950	1000	400	130	160	180	445	8,380.-	80.-
				520-1920	1050	1000	400	130	160	175	465	8,540.-	80.-
				560-1960	1050	1000	400	130	160	175	470	8,625.-	80.-
S 15 - BKR 22-SV	2200	500	2	520-1890	1150	1000	400	130	175	165	560	9,095.-	90.-
				500-1940	1150	1000	400	130	175	165	560	9,315.-	90.-
				500-2040	1250	1000	400	130	175	160	575	9,675.-	90.-
S 15 - BKR 28-SV	2800	500	3	520-1890	1150	1000	400	150	175	175	585	10,000.-	105.-
				500-1940	1150	1000	400	150	175	175	585	10,240.-	105.-
				500-2040	1250	1000	400	150	175	170	595	10,630.-	105.-
S 15 - BKR 35-SV	3000	600	3	500-2040	1250	1200	400	150	185	195	730	11,750.-	120.-
				500-2130	1350	1200	400	150	185	190	745	12,160.-	120.-
				500-2230	1450	1200	400	150	185	185	760	12,570.-	120.-
S 15 - BKR 40-SV	3900	600	3	500-2130	1350	1200	400	150	195	190	755	13,180.-	130.-
				500-2230	1450	1200	400	150	195	185	775	13,630.-	130.-
S 15 - BKR 45-SV	4200	600	4	500-2130	1350	1200	500	150	195	200	835	15,710.-	140.-
				500-2230	1450	1200	500	150	195	195	860	16,395.-	140.-

- Surcharge for adjustable pressure relief valve € 320.-
- Surcharge for pressure gauge € 120.-
- Further opening ranges on request.
- Details on sideshift valve, see page 9.
- Available without sideshift.

- The opening range between the clamp arms is measured on the frame. Due to a prestress (1°) the opening range between the tips is correspondingly smaller.

See page 135 for standard values for the residual load capacity of lift trucks.

Standard values for residual load capacity of lift trucks**

Recycling Clamp (see page 134)

Recycling Clamps with Sideshift Valve	S 15 -	BKR 15-SV	BKR 15-SV	BKR 22-SV	BKR 22-SV	BKR 28-SV	BKR 28-SV	BKR 35-SV	BKR 40-SV	BKR 40-SV	BKR 40-SV	BKR 45-SV
Load capacity lift truck	kg	1500	2000	2000	2500	3000	3500	3500	4000	4500	5000/500	5000
X*	mm	350	450	450	450	450	500	500	500	500	500	560
LC (LSP) = 500 mm	kg	1130	1610	1530	1970	2390	2880	2755	3160	3600	4100	4520
LC (LSP) = 600 mm	kg	1025	(1380)	1400	1800	2190	(2570)	2530	2910	3310	3370	4170
LC (LSP) = 700 mm	kg	935	(1180)	1290	1660	2020	(2200)	2340	2690	3060	3485	3875

** The load capacity applies to lifting heights up to 3300 mm; specifications for greater lifting heights on request.

* Assumed dimensions

- For greater load centers, where the lift truck has a higher residual load capacity than the attachment, those values, upon the exceedance of which the attachment would be overloaded, are indicated in brackets ().

Bale Clamps in Use



S15



Foam Clamps

1 hydraulic function

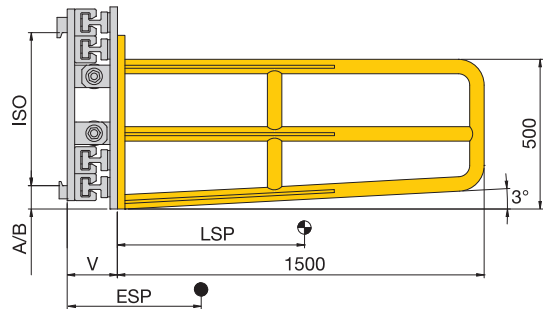
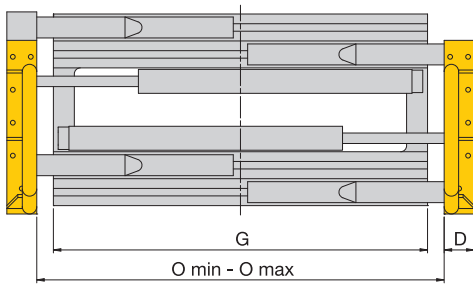

Clamp arms serially bolted on

Model	Load capacity	LC (LSP)	ISO	Omin-Omax	G	D	V	CoG (ESP)	Weight	Price	Surcharge per 100 mm add. arm length or height
				mm							
S 15 - BKS 10	600	800	2	540-1600	950	100	155	225	385	8,205.-	95.-
				800-2200							
S 15 - BKS 15	950	800	2	760-2260	1150	100	155	205	445	9,075.-	95.-
				730-2430							

- Surcharge for sideshift valve S 15 - BKS ... SV € 670.-
- Surcharge for adjustable pressure relief valve € 320.-
- Surcharge for pressure gauge € 120.-
- Further opening ranges on request.
- Version with separate sideshift on request.
- Rotatable version on request.

- For details on sideshift valve, see page 9.
- The opening range between the clamp arms is measured on the frame. Due to a prestress (1°) the opening range between the tips is correspondingly smaller.

Standard values for residual load capacity of lift trucks**

Foam Clamps	S 15 -	BKS 10	BKS 10	BKS 15	BKS 15
Load capacity lift truck	kg	1000	1200	1500	2000
X*	mm	300	350	350	450
LC (LSP) = 600 mm	kg	620	800	1020	(1395)
LC (LSP) = 800 mm	kg	520	(660)	860	(950)
LC (LSP) = 1000 mm	kg	450	(530)	740	(835)

** The load capacity applies to lifting heights up to 3300 mm; specifications for greater lifting heights on request.

* Assumed dimensions

- For greater load centers, where the lift truck has a higher residual load capacity than the attachment, those values, upon the exceedance of which the attachment would be overloaded, are indicated in brackets ().

S15

BOX DUMPERS

Box dumpers are used for sideward emptying of pallet cages and other bins without pockets. The load is picked up by the forks and also held by the clamp arms during the rotation process. For delicate bins rubber-coated contact pads are available.

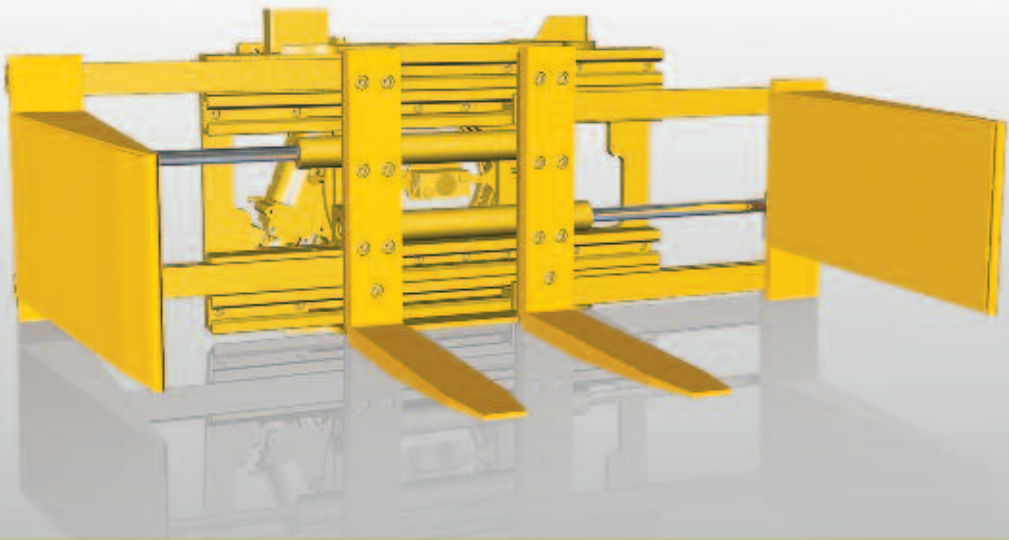

Box Dumpers

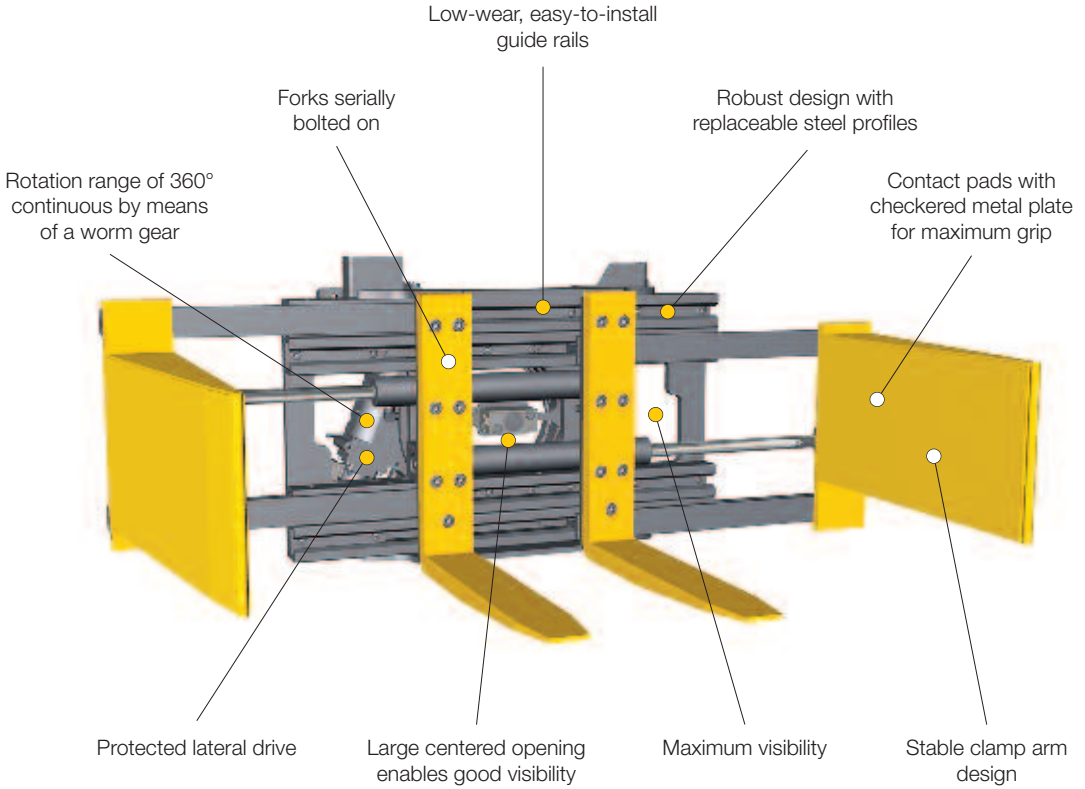

S15

Special equipment

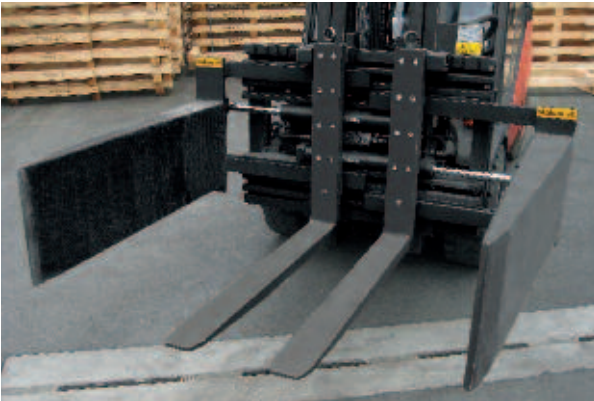

Manually adjustable forks

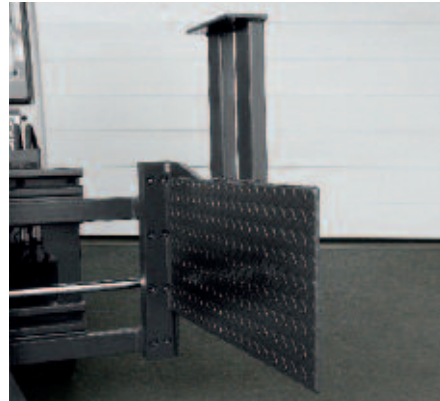

Clamp arm with additional load-securing device

Box Dumpers, Rotatable

2 hydraulic functions

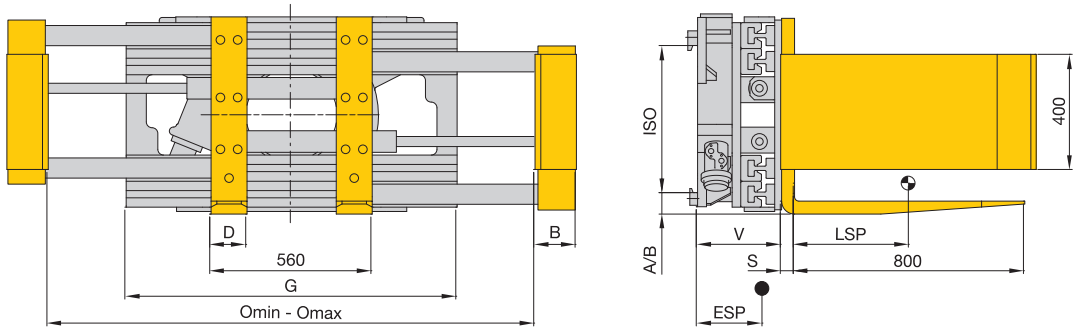

Forks serially bolted on · Rotation range 360°

Model	Load capacity	LC (LSP)	ISO	Omin-Omax	G	B	D	S	V	CoG (ESP)	Weight	Price	Surcharge per 100 mm add. arm / fork length
	kg	mm		mm	mm	mm	mm	mm	mm	mm			
S 15 - GBE 15-360°	1500	500	2	700-1700	1050	120	120	40	270	240	750	16,475.-	155.-
S 15 - GBE 20-360°	2000	500	2	700-1700	1050	125	125	45	275	245	770	17,180.-	165.-
S 15 - GBE 25-360°	2500	500	3	700-1700	1150	150	125	45	285	245	890	19,480.-	175.-

- Surcharge for adjustable pressure relief valve € 320.-
- Surcharge for pressure gauge € 120.-
- Surcharge for rubber coating of the arms' contact pads € 1,105.-
- Different arm coatings on request.
- Version with manually adjustable forks on request.
- Due to a prestress (1°) the opening range between the tips is 30 mm smaller (please note in case of deviating arm lengths).

Standard values for residual load capacity of lift trucks**

Box Dumpers, rotatable	S 15 -	GBE 15-360°	GBE 15-360°	GBE 20-360°	GBE 25-360°	GBE 25-360°
Load capacity lift truck	kg	1500	2000	2500	3000	3500
X*	mm	350	450	450	450	500
LC (LSP) = 400 mm	kg	890	1350	1750	2080	2540
LC (LSP) = 500 mm	kg	820	1240	1610	1910	2340
LC (LSP) = 600 mm	kg	750	1150	1490	1770	2170

** The load capacity applies to lifting heights up to 3300 mm; specifications for greater lifting heights on request.

* Assumed dimensions

